



**HOHMANN & BARNARD, INC.**  
A MiTek - BERKSHIRE HATHAWAY COMPANY

# Moisture Protection

## Enviro-Barrier™ VP

### Vapor Permeable Air Barrier

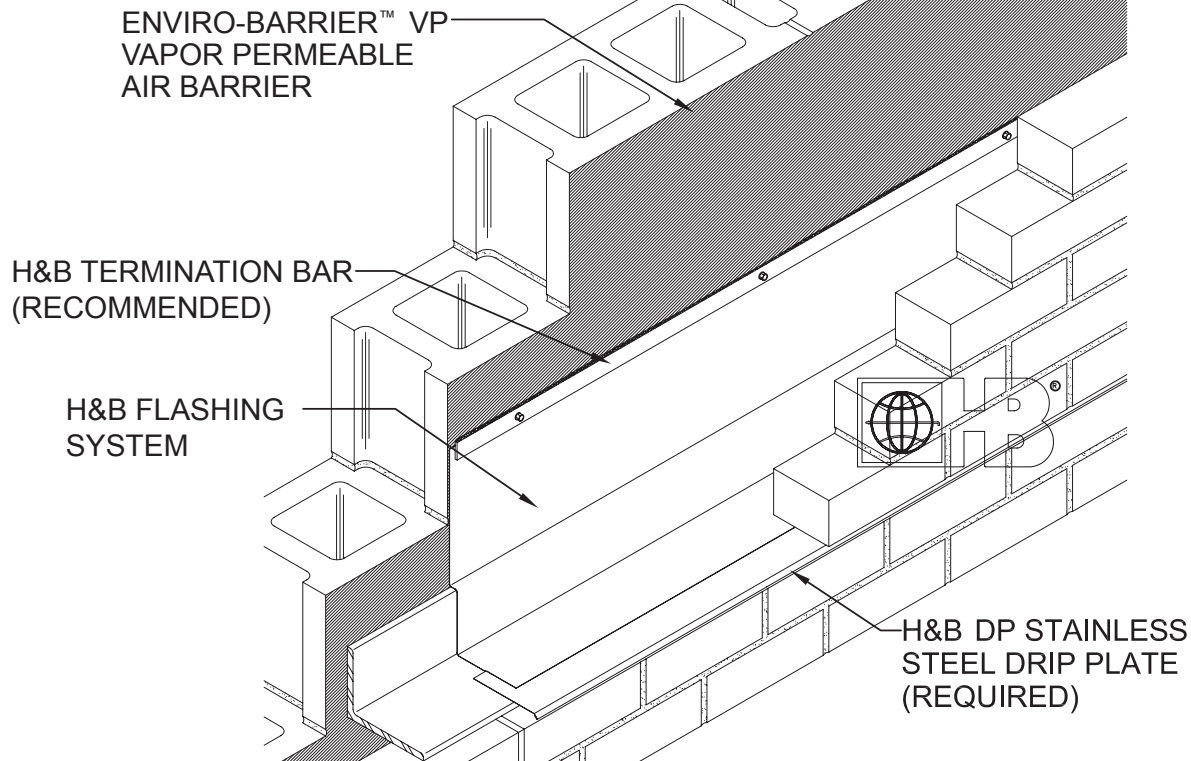

DRAWINGS FOR ILLUSTRATIVE PURPOSES ONLY

**ENVIRO-BARRIER™ Vapor Permeable Air Barrier**  
Single component, fluid applied, elastomeric membrane

**Product Description:**

- Elastomeric membrane for above grade wall assemblies.
- Asphalt free formulation.
- VOC-Free, HAP's-Free & Asbestos-Free.
- Remains flexible over a wide temperature range.
- Exceeds the highest industry standards for air barrier performance.
- Maintains excellent adhesion on most construction materials.
- Cost effective.

**Basic Uses:**

H&B's Enviro-Barrier™ VP features an asphalt-free formulation and maintains excellent adhesion on most construction materials including exterior gypsum board, CMU, concrete, stone, metal and much more.

**Application:**

Enviro-Barrier™ VP must be applied to a surface that is free from all foreign matter. This material should remain dry until it has cured. Enviro-Barrier™ VP, can be brushed, rolled, or sprayed; and should only be applied to above grade wall assemblies. Visit [h-b.com](http://h-b.com) for detailed instructions.

<b>Color:</b>	Light Blue Curing to Blue
<b>Coverage Rate:</b>	
CMU/CONCRETE:	60 sq. ft. (25 mils wet) per gallon
EXTERIOR SHEATHING:	75 sq. ft. (20 mils wet) per gallon
<b>Solids by Weight:</b>	65%
<b>Weight Per Gallon:</b>	10.2 pounds
<b>Perm Rating :</b>	10 perms (ASTM E-96)
<b>UV Resistance:</b>	Up to 120 Days
<b>Application Temperature:</b>	40° – 120° F
<b>Recyclables By Weight:</b>	30%
<b>Dry Time:</b>	
<b>Tack Free:</b>	2 – 4 hrs
<b>Full Cure:</b>	4 – 24 hrs
<b>Testing:</b>	<b>ASTM E2178, ASTM E96, and ASTM E2357</b>
<input type="checkbox"/>	5 Gallon Pail
<input type="checkbox"/>	55 Gallon Drum

**HOHMANN & BARNARD, Inc.**  
30 Rasons Court | Hauppauge, NY 11788  
CORPORATE HEADQUARTERS  
T: 800.645.0616 F: 631.234.0683  
[www.h-b.com](http://www.h-b.com)

**Branch/Subsidiary Locations:**  
ALABAMA - ILLINOIS - MARYLAND  
NEW YORK - PENNSYLVANIA - TEXAS  
CANADA

© HOHMANN & BARNARD, INC. - 2012